

# How to delete an animal

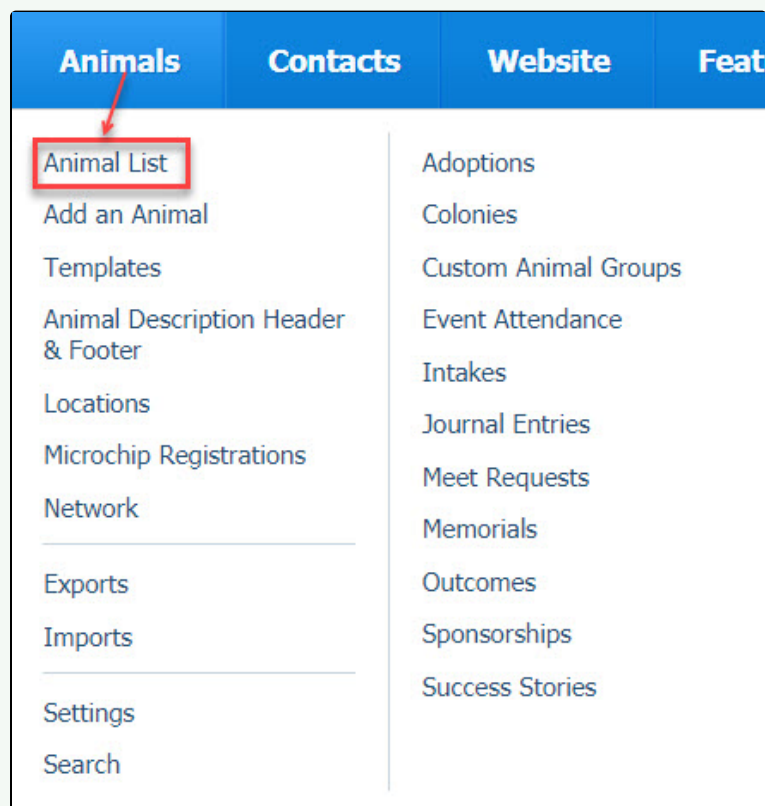

## Where do I find it?

You can delete an animal from the animal list. Go to **Animals > Animal List**.



## On this page:

- [Deleting an animal from your organization's list](#)

## Related pages:

- [How to restore a deleted animal](#)

## Deleting an animal from your organization's list

To delete an animal:

1. Navigate to the **Animal List**.
2. Scroll to the animal you want to delete.
3. Select the **checkbox next to the animal(s)** you want to delete. To bulk delete many records, you can select the **All** checkbox to select all animal records currently displayed in your datatable. By selecting **Show Max** from the Options menu, you can delete 250 records at once.
4. Select **Delete** from the **Actions** drop down.

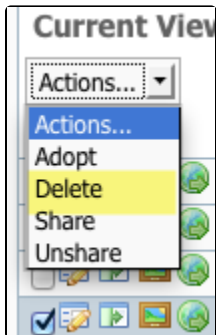

- You can also edit the animal and change the status to **Deleted**.

### Edit Aiden

« [Animals](#)

#### Basic Information

Name *	<input type="text" value="Aiden"/>
	(List: <a href="#">Male</a> <a href="#">Female</a>   Random: <a href="#">Male</a> <a href="#">Female</a> )
Status *	<input type="text" value="Deleted"/>
Species *	<input type="text" value="Choose one..."/>
Primary breed *	<input type="text" value="Deleted"/>
Secondary Breed	<input type="text" value="Domestication"/>
	<input type="text" value="Euthanized"/>
	<input type="text" value="Free Breeding"/>



When you delete an animal you are really just setting the animal's status to **Deleted**. That means you can go back and change the status if necessary. You can find all deleted animals on the **Data Recovery** page. See the chapter [Using data recovery](#) for information about recovering deleted data.

Deleted animals may be purged after 30 days, at which time they will be permanently removed from the system and cannot be recovered. See the chapter [Managing animal status](#) for information about changing animal statuses and to read a description of each status.

## Popular Questions

Topics:

- [animals](#)

1. 0  
votes

### [Linking support for an animal to payment](#)

- 0 answers
- [Andrea Homan](#)
- Apr 24, 2024
- [animals](#)

2. 0  
votes

### [How do I get my listings to automatically feed to Facebook?](#)

- 2 answers
- [Jennifer Myers](#)
- Mar 20, 2024
- [animals](#)
- [website](#)
- [exports](#)
- [facebook](#)
- [iframe](#)

3. 0  
votes

**How can we embed our available or adopted animal data stored in RescueGroups.org for display on an external website service?**

- 4 answers
- [Whiskers & Tails Rescue Foundation](#)
- Sept 21, 2023
- Space: [Website Service Guide](#)
- [website](#)
- [exports](#)
- [animals](#)
- [toolkit](#)

4. 0  
votes

**My Animal List is empty**

- 2 answers
- [Tammy Mullins](#)
- Feb 06, 2024
- [animals](#)

5. 0  
votes

**Requests**

- 0 answers
- [Anita Lowman](#)
- Feb 19, 2024
- [requests](#)
- [animals](#)

6. 0  
votes

**Add a mixed breed choice for dogs**

- 1 answer
- [Richard \[RG\]](#)
- Feb 27, 2014
- [requests](#)
- [animals](#)
- [breeds](#)
- [exports](#)

7. 0  
votes

**Change default location to "no"**

- 1 answer
- [Alana Woodbury](#)
- Jan 22, 2024
- [animals](#)
- [exports](#)

8. 0  
votes

**What fields is the Asilomar Advanced Animal Statistics report pulling from**

- 0 answers
- [Alana Woodbury](#)
- Jan 20, 2024
- [animals](#)

9. 0  
votes  
status

**Is there a way to view relationship from the Animal List page?**

- 1 answer
- [Michelle Caylor](#)
- Dec 08, 2023
- [animals](#)

10. 0  
votes  
status

**Can we increase the information exported to Adopt-A-Pet to include relationships?**

- 1 answer
- [Michelle Caylor](#)
- Dec 08, 2023

- [animals](#)
- [exports](#)

**Have a question about this topic?**